

BUILDING A FOOD TRUCK

Hi!
My name's Kiah,
and I built a Food
Truck!

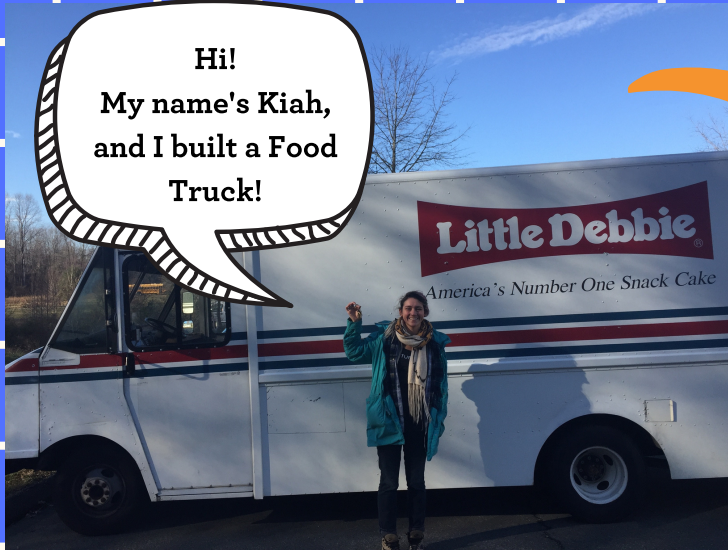

My Food Truck is
called Wilde
Thyme.



I built the truck so
that I could serve
local food around
Baltimore.



I've been the owner
and chef for 4 years
and love teaching
people about it.



BUILDING A FOOD TRUCK



I built my food truck from an empty delivery van, an old Little Debbie truck. The transformation from an empty truck into a kitchen on wheels took me several months. There were a few steps to designing the truck that came before building it.

First, I had to know what I was cooking and how I wanted to cook it. Luckily, I had worked on a food truck before and knew my menu, so I knew exactly what equipment I was going to need. For example I knew I needed a fridge and a griddle.

Then, I needed to figure out how big the equipment I needed was. This I could do through researching what I needed. For example, I wanted a stove that was 24 inches wide.

Finally, once I knew all the equipment I needed AND how big it was, I could figure out how it all would fit in the truck. It was like a big metal puzzle! It took me a little problem solving to get it just right, but in the end, it was perfect!

Would you like to try and solve the big metal puzzle?

BUILDING A FOOD TRUCK

Below is a step by step process you can use to figure out how you are going to fit a kitchen into a truck. You will need: 2 pieces of graph paper, scissors, and a pen or pencil. Follow along to learn!

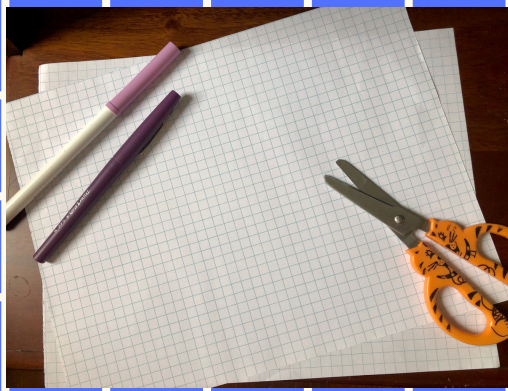

Step 1: Start with two pieces of graph paper.

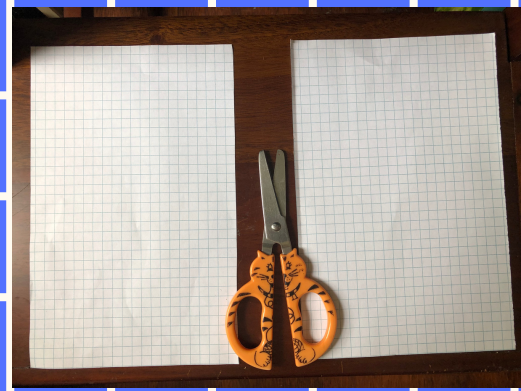

Step 2: Take one of the pieces and cut it in half.

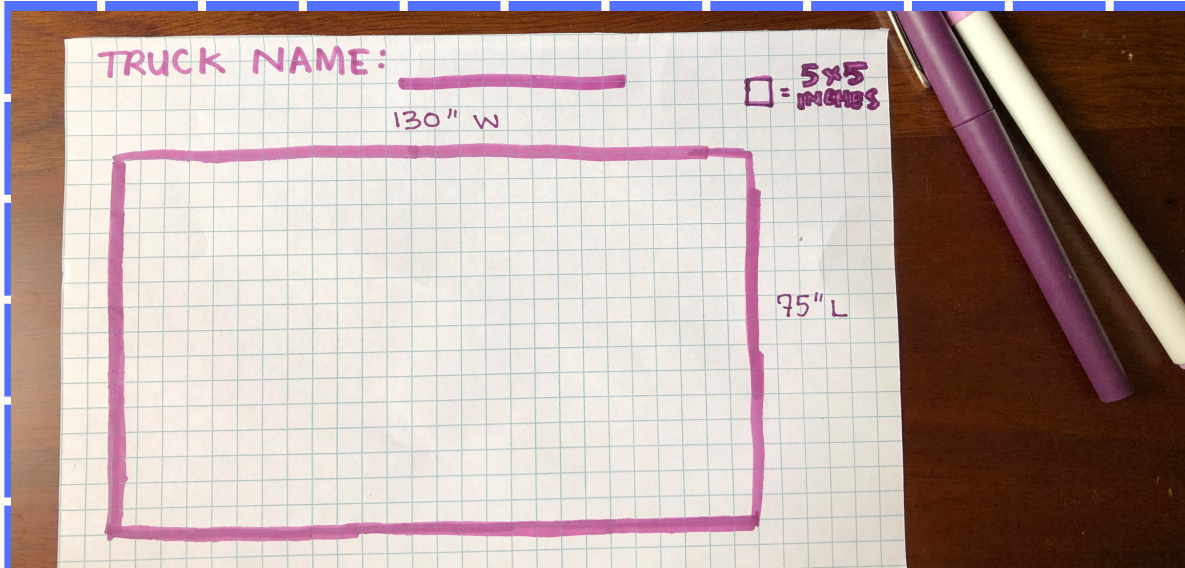

Step 3: Each square of your graph paper will represent 5x5 inches. On one of the cut pieces of paper draw a rectangle that is 26 squares wide and 15 squares long to represent a truck that is 130 inches wide and 75 inches long.

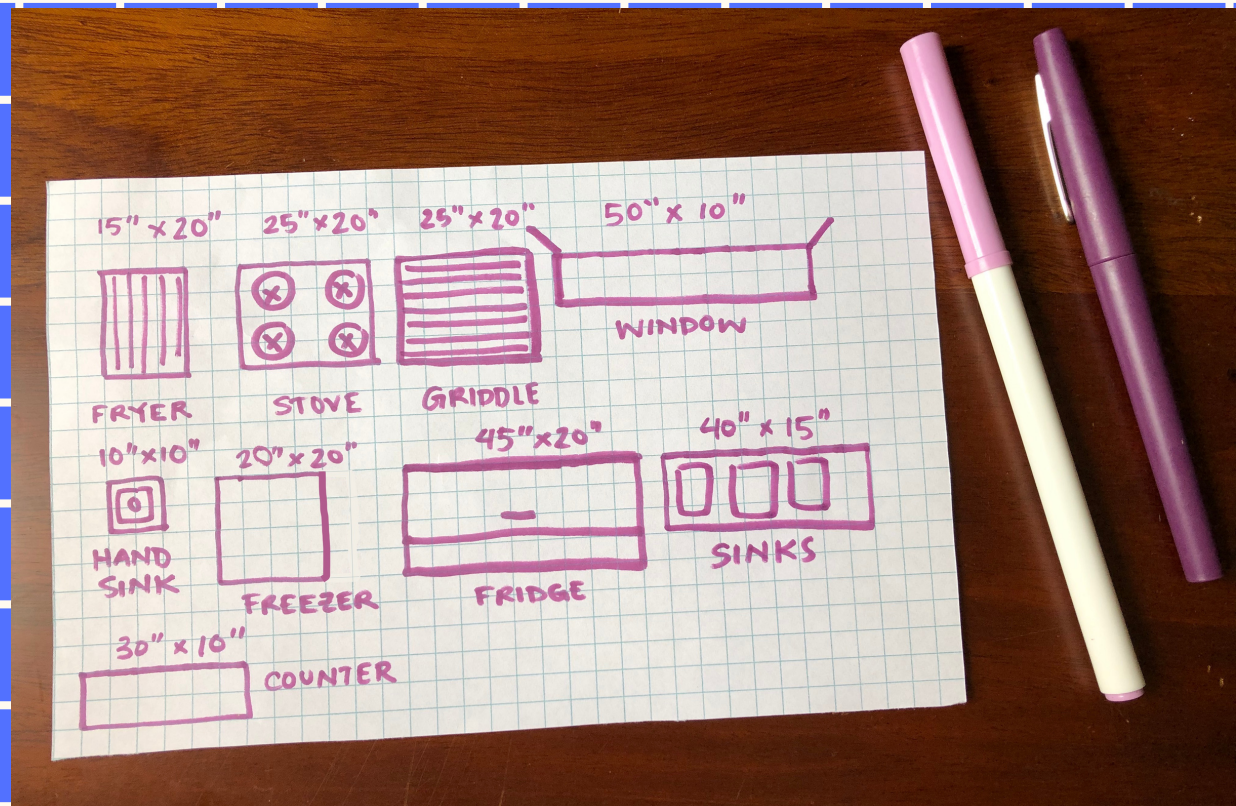

Step 4: On the second piece of paper draw out all the equipment we need to fit in the truck. Color them in so that you can tell which on is which. FRYER: 15"x20", STOVE: 25"x20", GRIDDLE: 25"x20", WINDOW: 50"x10", HAND SINK: 10"x10", FREEZER: 20"x20", FRIDGE 45"x20", SINKS: 40"x15", COUNTER: 30"x10". To help figure out how many squares to draw use the 5 Times Table below.

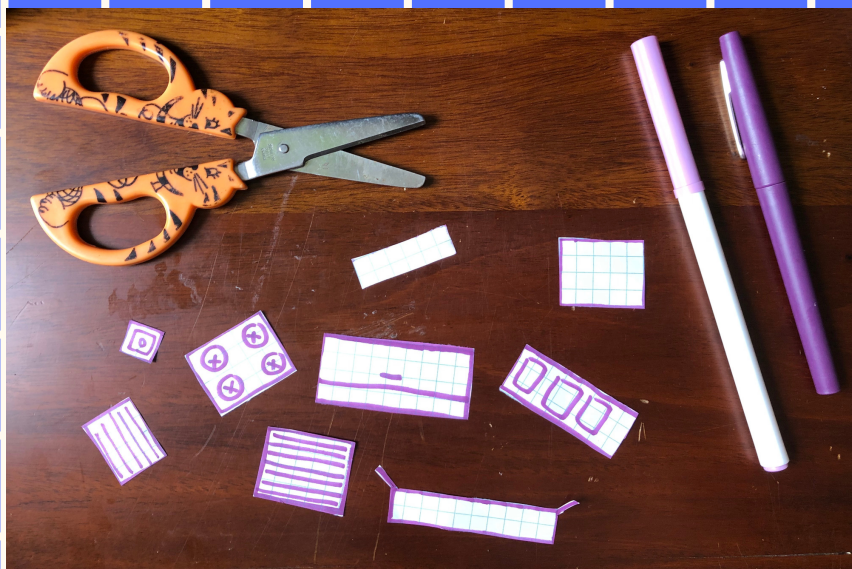

5 Times Table:

5x1=5	5x7=35	5x13=65
5x2=10	5x8=40	5x14=70
5x3=15	5x9=45	5x15=75
5x4=20	5x10=50	5x16=80
5x5=25	5x11=55	5x17=85
5x6=30	5x12=60	5x18=90

Step 5: Once you've drawn each piece of equipment, go through and cut each of them out.

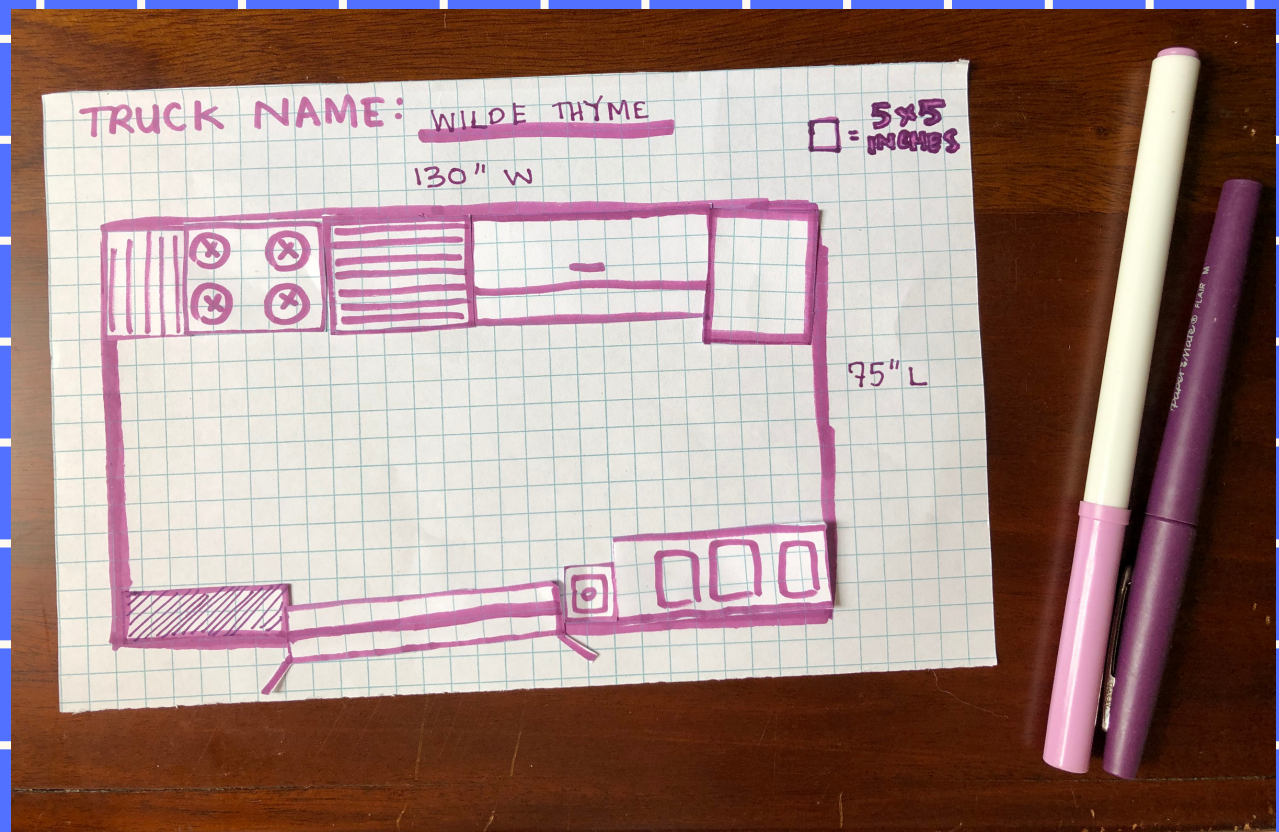

Step 6: Once you have cut all the equipment pieces out, take the pieces and place them into your truck in a way that they will all fit together. If you have glue or tape tape the pieces of down to the page. Once you've fit everything inside, feel free to add more equipment to make it your own!

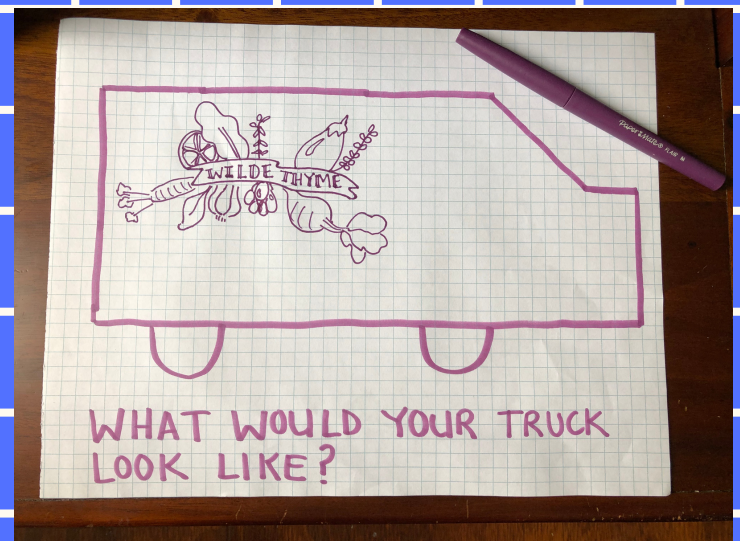
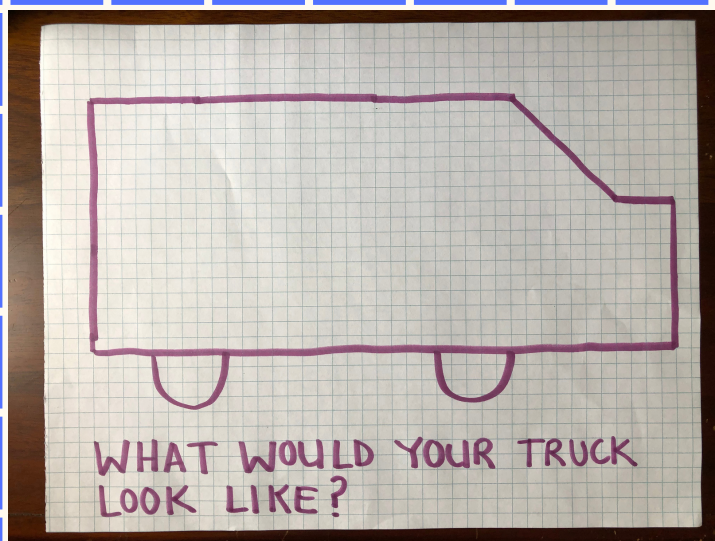

Step 7: as a final exercise design your trucks logo! What would you name your truck? What color would it be? Would you sell food? Or would you design the inside to be something different, like a stage, or a barber's shop, or something else? What can you do in a food truck?